

Uplift lbs
Clip on Both Face
1640

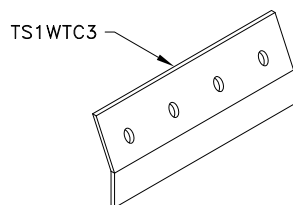

TS1WTC3 is 10g – base metal thickness (t) = 0.128 in.

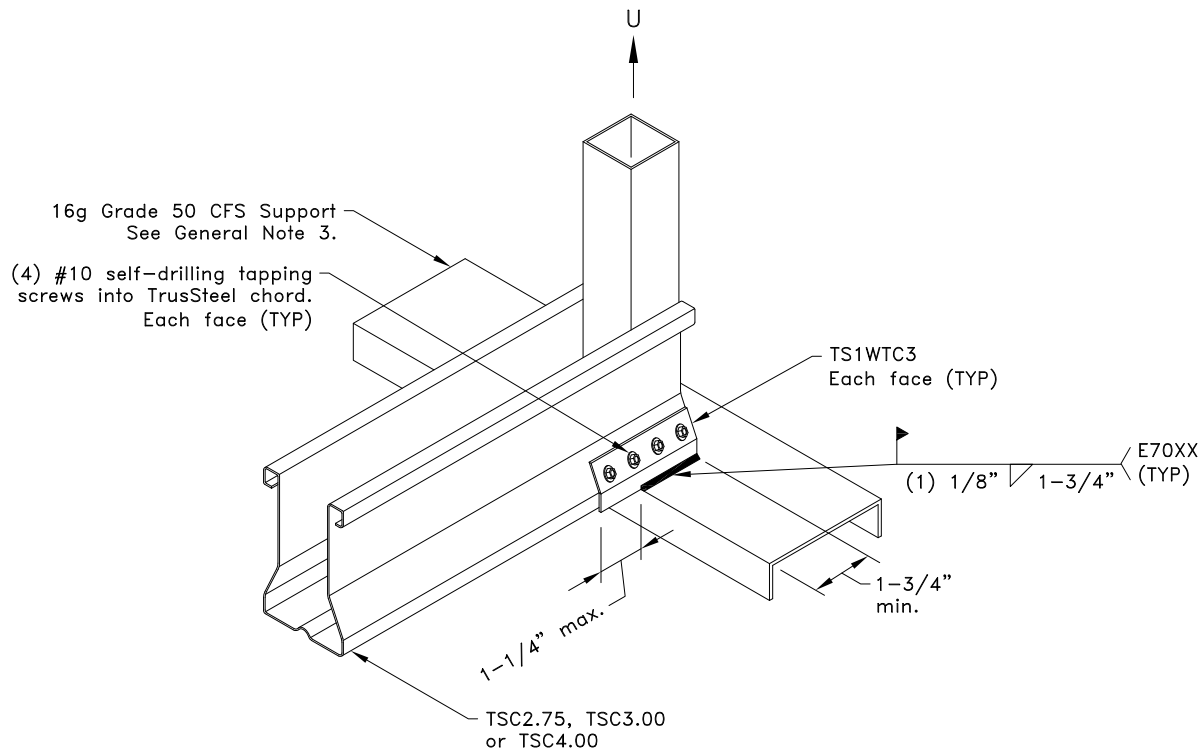

#### General Notes:

1. Attach the second clip to the opposite face of the chord as detailed.
2. Connection of top plate to wall stud must be capable of transferring truss uplift load from wall top plate to wall stud.
3. The wall top plate is to be designed by the job engineer. The wall top plate must be designed to support the loads applied to it (downward, upward and lateral).
4. U refers to Uplift.
5. Refer to TrusSteel Technical Bulletin 98.10.05 titled "Repair of Galvanized Surfaces" to restore corrosion resistant properties of the connection after welding.
6. Cold-Formed Steel Calculations are per the 2010 supplement to the AISI 2007 "North American Specifications for the Design of Cold-Formed Steel Structural Members" (S100-07/S2-10).



[www.TrusSteel.com](http://www.TrusSteel.com)

Florida: 2400 Lake Orange Drive, Suite 150 / Orlando, FL 32837 / (800) 755-6001  
Missouri: 13723 Riverport Drive, Suite 200 / Maryland Heights, MO 63043 / (800) 326-4102

## Welded Uplift Attachment To Cold-Formed Steel

Alpine, a division of ITW Building Components Group, Inc. shall not be responsible for any performance failure in a connection due to a deviation from this detail. Any variation from this detail shall be approved in advance by Alpine, a division of ITW Building Components Group, Inc.

#### Custom Detail:

CD150820

#### Date:

09/01/15

#### Custom Detail Category:

Truss-To-Bearing: Cold-Formed Steel